

**CUSTOM** by California Side Car **TRIKE** 

**POWER TRAK**

**INSTALLATION  
INSTRUCTIONS**

**2000 - CURRENT**

**SOFTAIL HARLEY-DAVIDSON**

**Excludes Rocker, Deuce,**

CALIFORNIA SIDECAR PARTS & TECHNICAL SUPPORT  
434.263.8866

## Warnings and considerations:

- 1.Disclaimer** - These instructions assume a level of understanding of motorcycle repair and maintenance beyond that of a “beginner” and/or “novice” and California Sidecar cannot be liable for an installer’s failure to understand or follow these instructions as written. Likewise, California Sidecar cannot be responsible if any of the steps are omitted or shortcuts are taken, or parts other than those supplied by California Sidecar are used.
- 2.“WARNINGS”** are all printed in bold type and capitalized. They mean to use extreme care in a given step so as not to damage the part, motorcycle, and/or yourself.
- 3.Always** wear safety glasses when using hand and/or power tools.
- 4.**When working in and around the fuel system, **always** work in a well-ventilated area, free from sparks and open flames.
- 5.**All directional references to the “right side” and the “left side” are as you were seated on the motorcycle.
- 6.**All directional references to “forward” mean to the front of the motorcycle while “back” means the rear of the motorcycle unless otherwise stated.
- 7.Warning:** The fork spring cap is under spring pressure; use care when removing it.

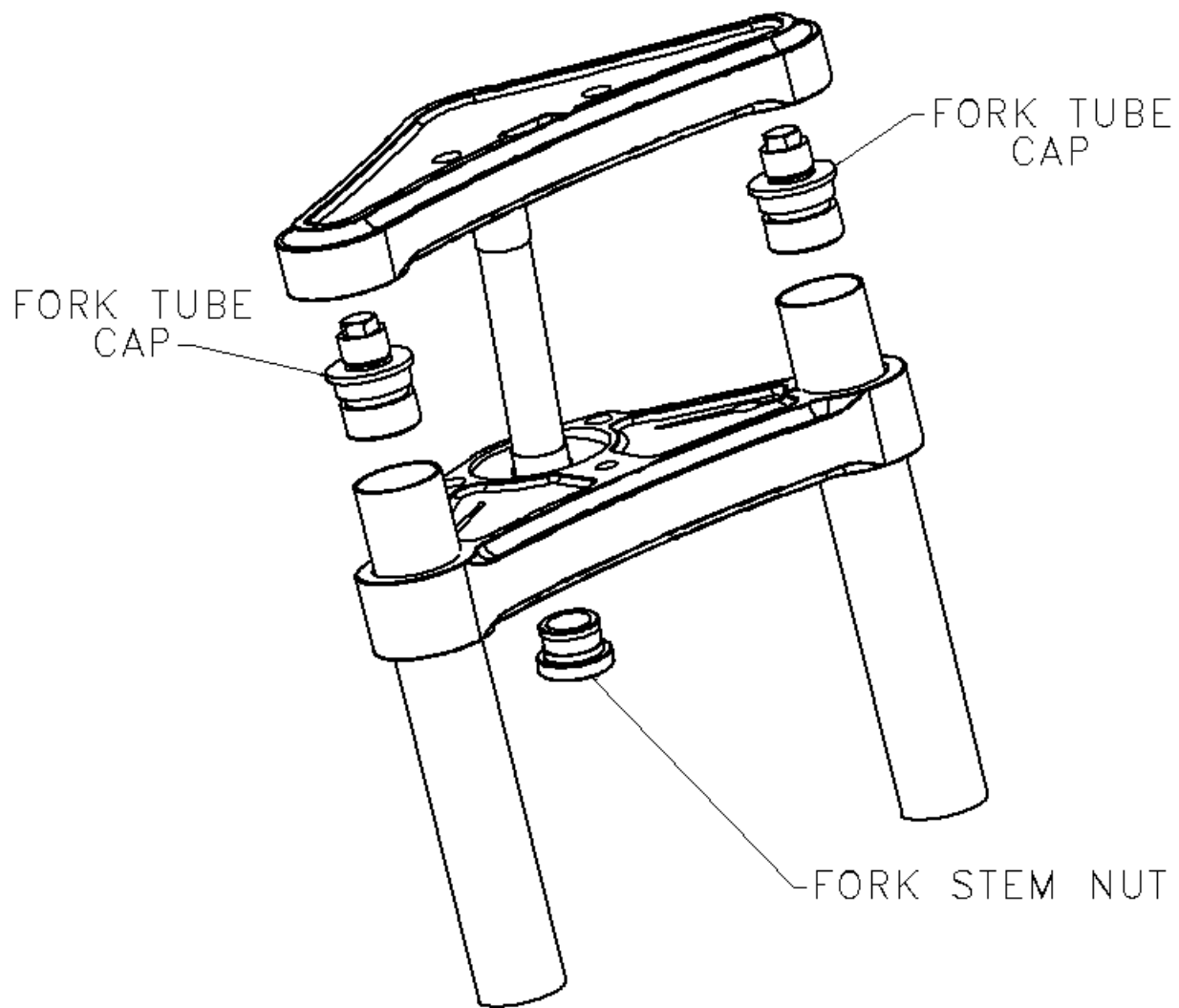

### **Disassembly:**

- 1. Refer to the Service Manual for the model Motorcycle that you are working on for disassembly.**
- 2. Remove front wheel, fender, fork tubes, fuel tank, headlight and turn signals and all connected wiring.**
- 3. Remove handle bars by removing the two riser bolts from under the upper triple clamp.**
- 4. Remove upper and lower triple clamps.**
- 5. Clean and Grease upper triple clamp bearing.**
- 6. Install upper triple clamp with stem down thru top of frame reusing dust shield and bearing. Bearing will be tight on the steering stem shaft.**

7. Grease new lower bearing and install onto steering stem with new seal.
8. Install lower triple clamp with steering stem nut.
9. Remove the fork caps and install the supplied threaded caps reusing the o-rings.
10. Install both fork tubes by sliding them thru the lower then threading them into the upper triple clamp. Tighten the fork tubes using a strap wrench.
11. Install the handle bar risers using two chrome 1/2-13 x 1 1/2 SHCS from underneath.
12. Torque the steering stem nut to 35 FT-LBS.
13. Install the steering stem nut set screw in the rear of the lower triple clamp.
14. Install two chrome 3/8-16 x 1 3/4 SHCS into the lower triple clamps as pinch bolts. Torque to 40 FT-LBS.
15. Route the handle bar wire harnesses behind the risers then down thru the upper triple clamp. Then reconnect them.
16. Install the headlight using a chrome 3/8-16 x 1 3/4 SHCS.
17. Route the headlight harness to its connector.

**NOTE:** If you have purchased the complete CUSTOM PWR TRAK skip to step 20. Otherwise continue.

18. Reinstall existing front wheel, caliper, fender, and axle. Refer to service manual.
19. Install front brake line. Route it down thru the hole in the upper triple clamp then thru the lower triple clamp and to the caliper. Install the straight fitting on the caliper with a crush washer. Install the line. Tighten all fittings and bleed the brake.
20. Install hand controls if equipped.

- 21. Install the left and right turn signals using the fork clamps. Install them above the lower triple clamp.**
- 22. Using the Y pig tail for the turn signals connect the left and right signals in and zip tie wires.**
- 23. Remove the lower covers from the fork tubes.**
- 24. Install front wheel using the axle from the fork tube box. Install the grooved spacer on the right hand side and smooth on the left. Tighten the axle on the wheel, and then reinstall fork covers.**
- 25. Install new front brake caliper using two 3/8-16 x 1 SHCS.**
- 26. Install the front fender using four chrome 5/16-18 x 3/4 BHCS and eight chrome 5/16 washers. Install in this order. Bolt and washer then through the fender second washer and finally thread into the fork. Use thread locking agent.**

**From all of us at California Sidecar.  
Enjoy the ride.**