

# DAYTONA California Side Car by TRIKE

## 2009 - CURRENT

### PRELOADER INSTALLATION

1.) **PRELOADER ASSEMBLY**

- 1 - Remote Adjuster
- 1 - Preloader Actuator
- 1 - Hydraulic Line

2.) **MOUNTING BRACKET**

- 1 - Mounting Bracket
- 1 - 5/16-18 x 1 3/4 HHCS
- 1 - 5/16-18 Nyloc Nut
- 2 - 5/16 Flat Washer
- 3 - 10-32 x 1 BHSCS

**ALL ORDERS ARE DOUBLE  
CHECKED TO ELIMINATE  
SHIPPING ERRORS.**

FILLED BY: \_\_\_\_\_

CHECKED & PACKED BY: \_\_\_\_\_

CALIFORNIA SIDECAR PARTS & TECHNICAL SUPPORT  
434.263.8866

## Warnings and considerations:

- 1.Disclaimer** - These instructions assume a level of understanding of motorcycle repair and maintenance beyond that of a “beginner” and/or “novice” and California Sidecar cannot be liable for an installer’s failure to understand or follow these instructions as written. Likewise, California Sidecar cannot be responsible if any of the steps are omitted or shortcuts are taken, or parts other than those supplied by California Sidecar are used.
- 2.“WARNINGS”** are all printed in bold type and capitalized. They mean to use extreme care in a given step so as not to damage the part, motorcycle, and/or yourself.
- 3.Always** wear safety glasses when using hand and/or power tools.
- 4.**When working in and around the fuel system, **always** work in a well-ventilated area, free from sparks and open flames.
- 5.**All directional references to the “right side” and the “left side” are as you were seated on the motorcycle.
- 6.**All directional references to “forward” mean to the front of the motorcycle while “back” means the rear of the motorcycle unless otherwise stated.

## **Preloader Installation:**

- 1. Install the Mounting Bracket onto the Remote Adjuster using the three 10-32 x 1 BHSCS.**
- 2. Remove 5/16-18 x 1 1/2 HHCS from the right front seat mount.**
- 3. Remove and discard Torx bolt from rear of the battery box.**
- 4. Snip the end off of the side cover grommet to allow for preloader adjustment.**
- 5. Install 5/16-18 x 1 1/2 HHCS with Flat Washer removed in step 2 into threaded hole in frame and tighten.**
- 6. Install 5/16-18 x 1 3/4 HHCS and Flat Washer thru frame and seat mount.**
- 7. Install Remote Adjuster onto the two HHCS with the slot to the rear.**
- 8. Install 5/16-18 Nyloc Nuts and Flat Washers.**
- 9. Tighten all fasteners.**

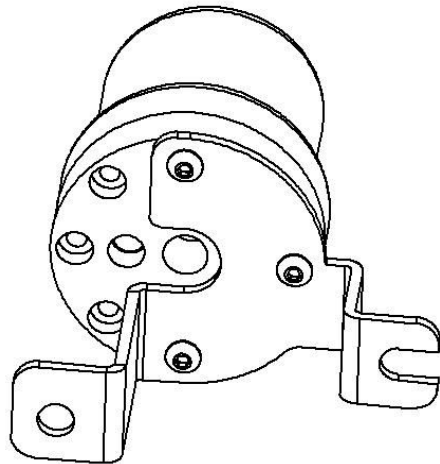

**From all of us at California Sidecar.  
Enjoy the ride!**