



## *Ground Effects* Installation Instructions

<input type="checkbox"/>	2 - Front mount clamp	GFX-0003
<input type="checkbox"/>	2 - Front mount	GFX-54758
<input type="checkbox"/>	1 - Front mount Spacer	GFX-78963
<input type="checkbox"/>	2 - Middle mount	GFX-95730
<input type="checkbox"/>	1 - M10-1.25 SHCS left hand	FST-30958
<input type="checkbox"/>	2 - M10 Washer	FST-18709
<input type="checkbox"/>	1 - 3/8-16 x 1 1/4 BHCS	FST-44434
<input type="checkbox"/>	1 - 3/8-16 x 3/4 BHCS	FST-83198
<input type="checkbox"/>	4 - 3/8 Washer S.S.	FST-37855
<input type="checkbox"/>	4 - 5/16-18 x 3/4 BHCS	FST-93056
<input type="checkbox"/>	4 - 5/16-18 x 1 1/4 BHCS	FST-64041
<input type="checkbox"/>	8 - 5/16-18 Nyloc nut	FST-72212
<input type="checkbox"/>	8 - 5/16 Washer S.S.	FST-61627
<input type="checkbox"/>	8 - 5/16 Fender washer	FST-36159
<input type="checkbox"/>	4 - 1/4-20 Elevator bolt	FST-55444
<input type="checkbox"/>	4 - 1/4-20 Nyloc nut	FST-33129
<input type="checkbox"/>	4 - 1/4 Washer	FST-77076
<input type="checkbox"/>	1 - Wiring harness	
<input type="checkbox"/>	4 - butt connector	

**ALL ORDERS ARE DOUBLE CHECKED  
TO ELIMINATE SHIPPING ERRORS.**

FILLED BY: \_\_\_\_\_

CHECKED/PACKED BY: \_\_\_\_\_

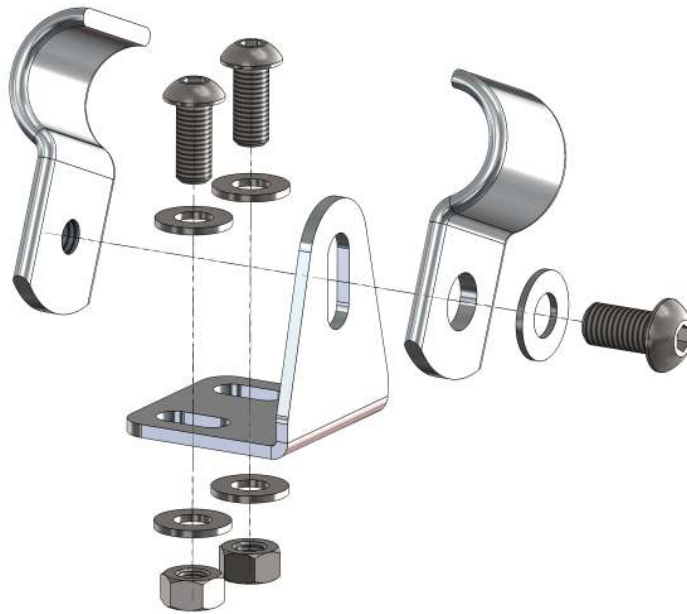

**LEFT SIDE FRONT MOUNT**

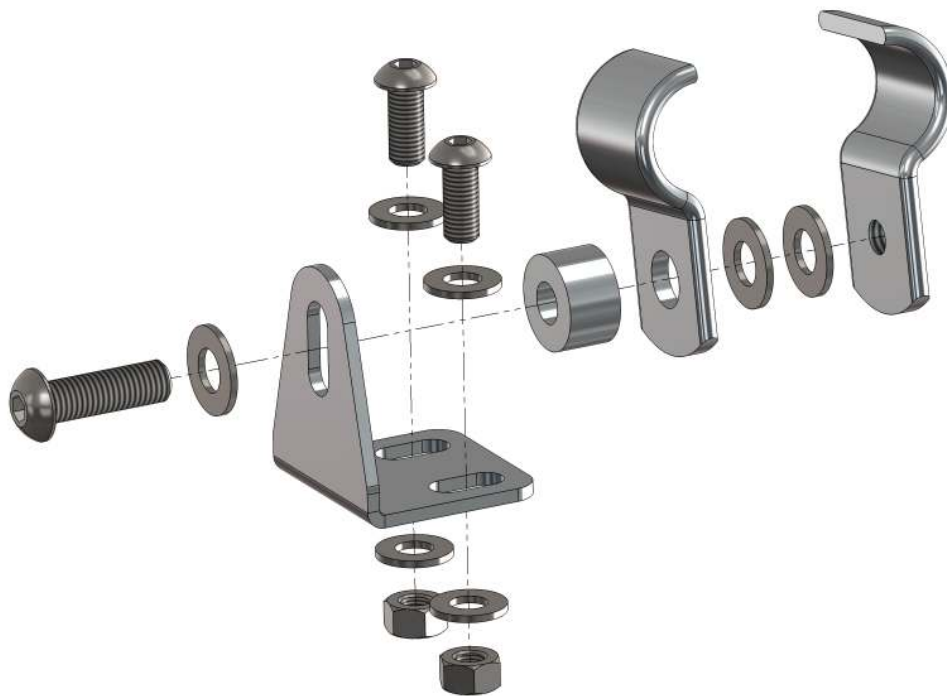

## RIGHT SIDE FRONT MOUNT

### IMPORTANT

**The California Sidecar *Ground Effects* are designed to fit the California Sidecar Viper Trike Conversion Kit only. The *Ground Effects* are designed and intended to ONLY ACCOMMODATE THE STOCK HONDA RIDER FOOTPEGS.**

### Wiring Installation:

1. Remove the seat and passenger grip handles with the four M8 x 1.25 SHCS.
2. Plug the four pin GRD EFX harness into the four pin connector at the body connectors (male and female 14 pin connectors).
3. Secure the GRD EFX box to the motorcycle frame or inner fender.

4. Route the purple and black wires to the left side and the brown and black wires to the right side.
5. Replace the seat and passenger grip handles with the four M8 x 1.25 SHCS.

### **Ground Effects Installation:**

1. Disconnect the three pin connector at the sidestand switch.
2. On the sidestand side of the connector cut 2 inches from the connector.
3. Strip the two green wires and connect them together with a butt connector.
4. Tape or shrink tube all three wires.
5. Remove the side stand.

### **Front mounts – (left & right)**

1. Cut opening in rubber boot 1/2" wide and 1 3/8" long. Refer to picture above.
2. Insert the two clamp halves through the opening in rubber boot with weld nut facing forward. It is not necessary to install top of clamp or the four BHCS.

### **Middle mount**

1. Remove the center stand. (Right side HHCS is left hand threads and the left side SHCS is right hand threads).
2. Install the middle mount reusing the OEM SHCS on the left side and a new M10 left hand SHCS on the right side.

Get both SHCS snug but not tight leaving the mount rotated down.

### **Fitting the Ground Effects:**

1. Lay **Ground Effects** into place aligning to the fender ensuring that the rear mating edge is level and the contoured fiberglass bracket is to the fender. Clamp bracket to fender (Vise-Grip®6-sp works well).
2. Adjust front of **Ground Effects** so there is a minimal gap between **Ground Effects** edge and lower cowl.

**Note:** In order to achieve optimum fit, you may find it necessary to grind slightly where the **Ground Effects** meet the motorcycle.

3. Loosely install the front mount to the clamp with the foot facing forward. The left side is sandwiched by the clamp and the right side use the spacer. BHCS with washer then the mount, spacer and sandwich two washers between the clamp.
4. Holding the **Ground Effects** in position, mark the location of the two front mount holes.
5. Remove clamp at rear and remove **Ground Effects**.
6. Drill two 5/16 holes at marked location.
7. Remove front mount from clamp and attach to **Ground Effects** (foot forward) with two 5/16 BHCS with 5/16 washers. Use 5/16 washers and nyloc nuts on the underside.
8. Place **Ground Effect** in position and clamp rear to fender as in step 1.

9. Install front mount as mentioned before with the two 3/8 BHCS and washers. Adjust **Ground Effect** location as in step 2, and tighten.

## Rear mounts

1. With clamp still in place, drill two 5/16" holes 3" up from bottom edge of fender ensuring holes go through fiberglass bracket approximately 1" from each side of bracket.
2. Install two 5/16 HHCS and fender washers, pointing forward, with the bolt head on the inside of the trike body fender well. **DO NOT INSTALL the bolt with the threads inside the fender well.** Secure with 5/16 fender washers and 5/16-18 nyloc nuts. Do not over tighten. Remove clamp.

## Middle mount

1. Rotate the mount up until it touches the **Ground Effect**.
2. Pull up the rubber mat where you are about to drill.
3. Using a 1/4 drill bit with an angle drill, drill up though the **Ground Effect** using the middle mount as a guide.
4. Install two 1/4-20 elevator bolts into the drilled holes and secure with nyloc nuts and washers.
5. Reglue the rubber mats.

## **Finish Wiring:**

- 1. Drill a 3/16” hole on each side of the trike body, above the mufflers but underneath the *Ground Effect*, to run the wiring harness through.**
- 2. Connect the left *Ground Effect* wiring harness to the installed wiring harness. The black wire to the black wire, and the purple wire to the purple wire with butt connectors.**
- 3. Connect the right *Ground Effect* wiring harness to the installed wiring harness. The black wire to the black wire, and the brown wire to the brown wire with butt connectors.**
- 4. Test the cornering lights to ensure that the lights operate with the appropriate turn signal, and the light remains illuminated until the turn signal is cancelled.**

**FROM ALL OF US AT CALIFORNIA SIDECAR.  
ENJOY THE RIDE.**